

RUTHERFORD COUNTY SCHOOL SYSTEM
2240 Southpark Drive
Murfreesboro, TN 37128

Special Called Board of Education Meeting
Tour School Sites

Minutes of February 20, 2016

Board Members Present

Wayne R. Blair, Chairman
Terry Hodge, Vice Chairman
Jim Estes
Aaron B. Holladay
Lisa Moore
Marvin D. Odom, Director of Schools

Rutherford County Commissioners

Rhonda Allen
Carol Cook
Phil Dodd
Joe Gourley
Pettus Read
Brad Turner

Board Members Absent

Jeff Jordan
Coy Young

Others Present

Gary Clardy
Richard Zago
Architect Joseph Binkley
Brian Wilson, Daily News Journal

1. CALL TO ORDER

At 8:30 A.M. the group departed from Central Office on a tour of four school sites.

2. TOUR SMYRNA MIDDLE SCHOOL

Mr. Steve Luker, Principal of Smyrna Middle School, joined the group to tour and to review the plan for the Smyrna Middle School Addition and Renovation. Architect Joseph Binkley was present to answer any questions regarding the renovations.

3. TOUR DAVID YOUREE ELEMENTARY SCHOOL

Mr. Scott Bolden, Principal of David Youree Elementary School, and past REA President Emily Mitchell welcomed the group at David Youree. Architect Joseph Binkley covered the David Youree Administrative Offices Plan. Mr. Bolden lead the tour and pointed out other areas of concern throughout the school and Mr. Clardy suggested that a Phase II Plan be submitted at a future date addressing these concerns once Rocky Fork Elementary School construction and rezoning were completed.

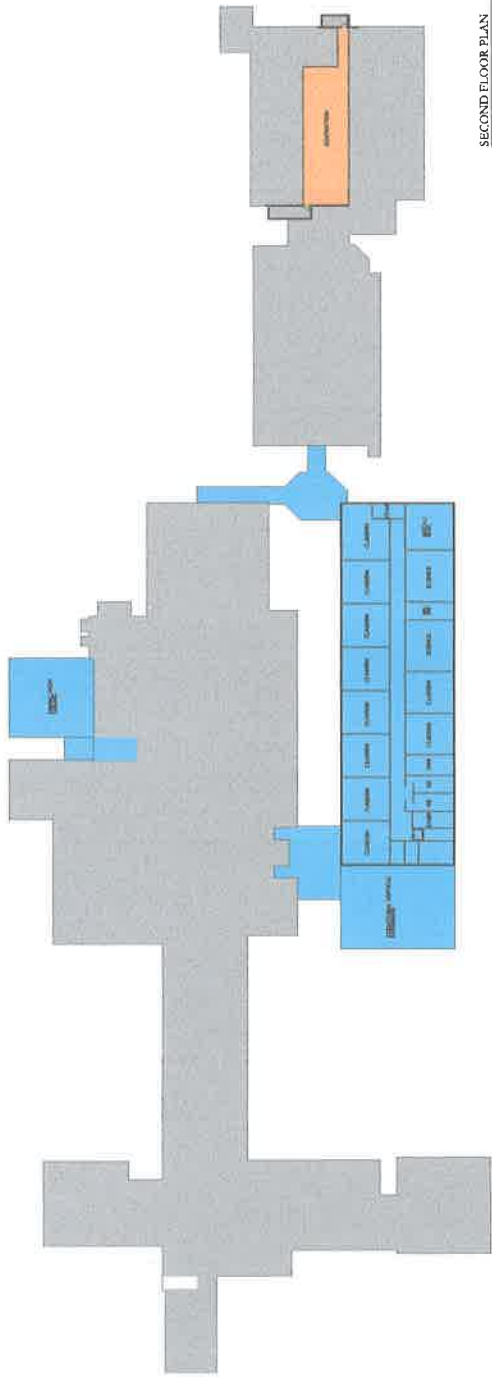

SECOND FLOOR PLAN

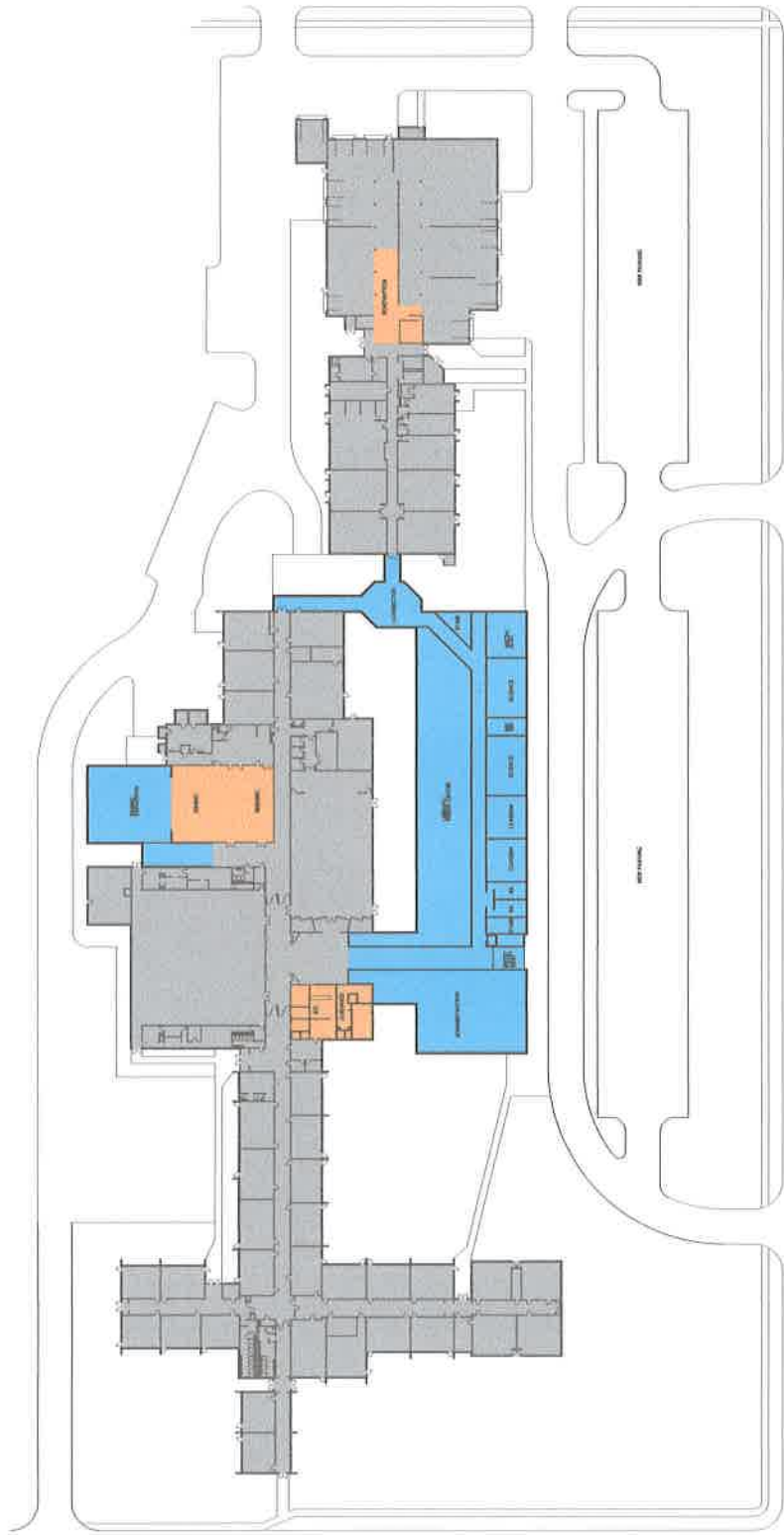

FIRST FLOOR PLAN

Smyrna Middle School
Additions & Renovation



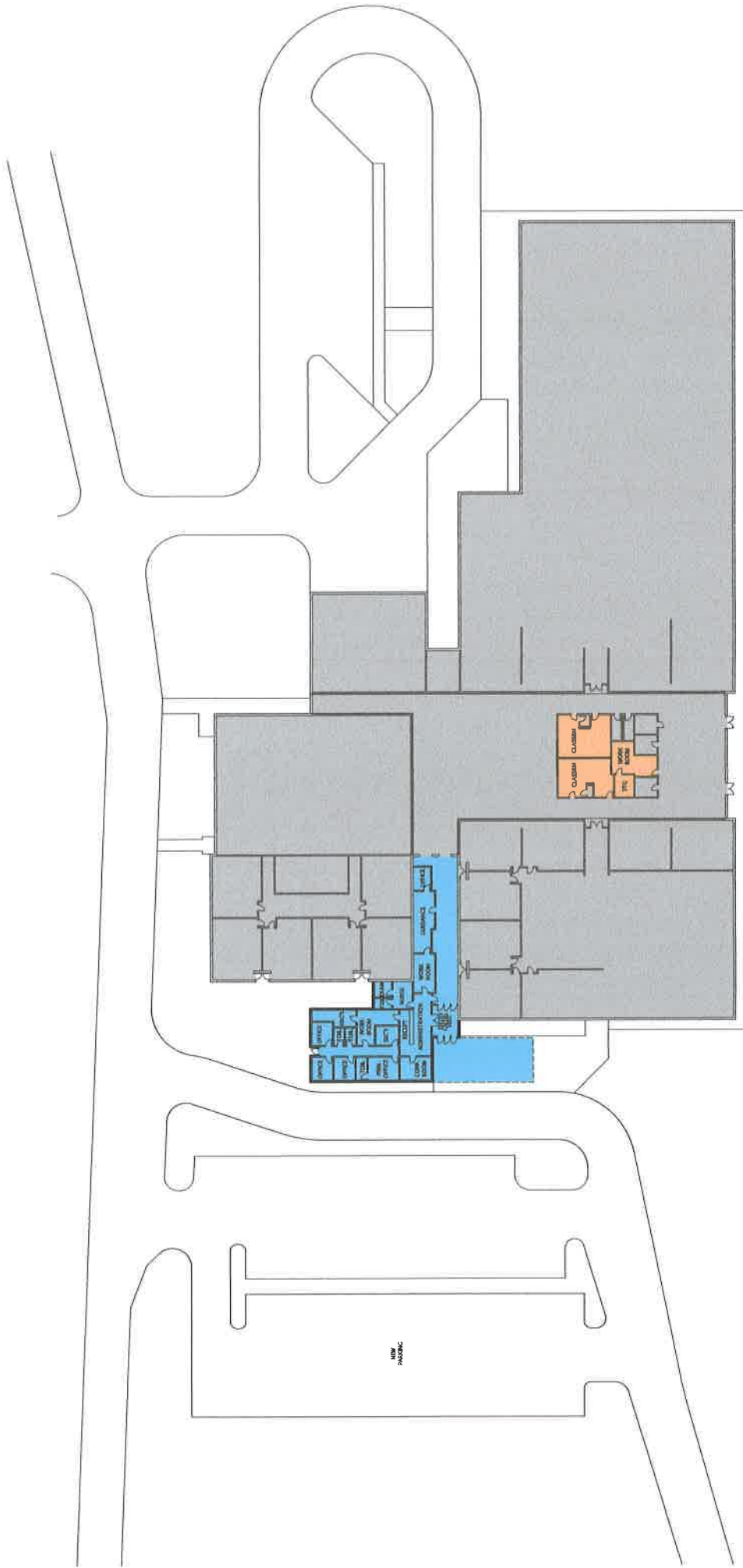

David Youree Elementary School
Addition & Renovation

BINKLEY | GARCIA
Architecture & Interior Design



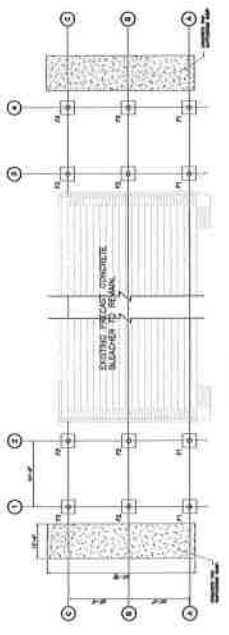

1. ALL DIMENSIONS ARE TO FACE UNLESS NOTED OTHERWISE.
 2. ALL DIMENSIONS ARE TO FACE UNLESS NOTED OTHERWISE.
 3. ALL DIMENSIONS ARE TO FACE UNLESS NOTED OTHERWISE.
 4. ALL DIMENSIONS ARE TO FACE UNLESS NOTED OTHERWISE.

NO.	DESCRIPTION	DATE
1	ISSUED FOR PERMIT	11/01/12
2	ISSUED FOR PERMIT	11/01/12
3	ISSUED FOR PERMIT	11/01/12
4	ISSUED FOR PERMIT	11/01/12

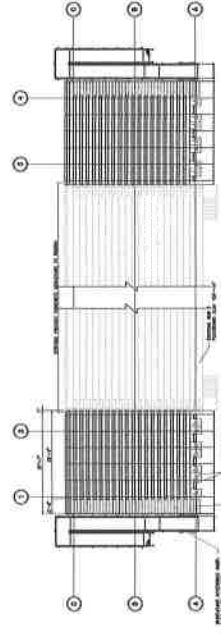
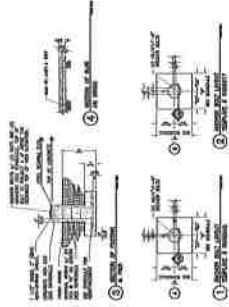

1. ALL DIMENSIONS ARE TO FACE UNLESS NOTED OTHERWISE.
 2. ALL DIMENSIONS ARE TO FACE UNLESS NOTED OTHERWISE.
 3. ALL DIMENSIONS ARE TO FACE UNLESS NOTED OTHERWISE.
 4. ALL DIMENSIONS ARE TO FACE UNLESS NOTED OTHERWISE.

1. ALL DIMENSIONS ARE TO FACE UNLESS NOTED OTHERWISE.
 2. ALL DIMENSIONS ARE TO FACE UNLESS NOTED OTHERWISE.
 3. ALL DIMENSIONS ARE TO FACE UNLESS NOTED OTHERWISE.
 4. ALL DIMENSIONS ARE TO FACE UNLESS NOTED OTHERWISE.

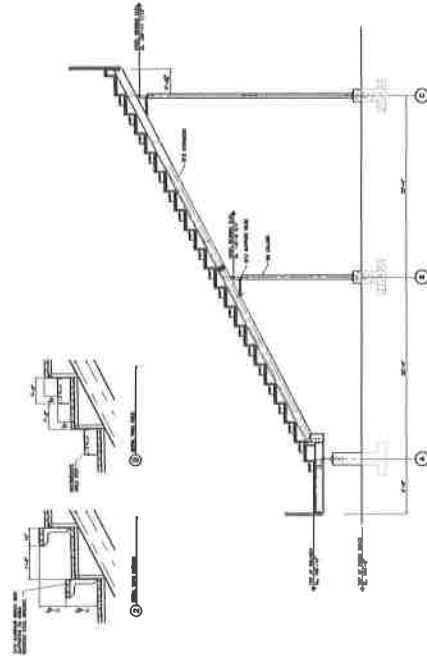
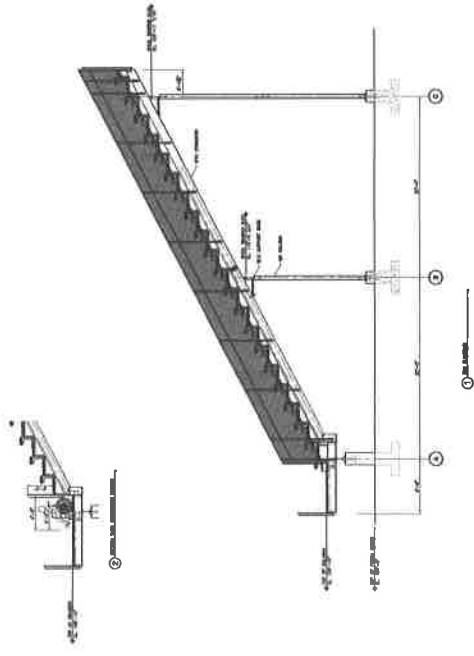

TOILET ACCESSORY LEGEND *	
MK DESCRIPTION	HEIGHT AFF **
C3 GRAB BAR - 36" LONG	37" TO CENTERLINE
C4 GRAB BAR - 42" LONG	37" TO CENTERLINE 800BT 12" BACK FROM BACK WALL
L HC LAVATORY	34" TO TOP OF BIA
M1 MIRROR - 1" MIN. x 50" MIN.	44" TO REFLECTING SURFACE
S1 SHOWER PAN/SHOWER WALL MIRROR - 36" MIN. x 48" MIN.	44" TO CENTERLINE AND 34" FROM CONTRIBUTE TO BACK WALL
T1 TOILET TISSUE DISPENSER - Surface Mounted	37" - 18" TO TOP OF SEAT
W HC WATERCLOSET	17" MARK TO TOP OF SEAT
U HC URINAL	ALL LISTED HEIGHTS MAY NOT BE USED.
	* REFER TO LATEST REVISIONS FOR ITEMS LISTED IN THE INSTRUCTIONS. ALL LISTED HEIGHTS MAY NOT BE USED.
	** CONSTRUCTION TO REVIEW GRAB BAR LAYOUT FOR COORDINATION WITH TUB/WALVE AND OTHER SPECIFIED
	ITEMS. GRAB BAR LAYOUT SHALL BE COORDINATED WITH TUB/WALVE AND OTHER SPECIFIED ITEMS. GRAB BAR
	ITEMS SHALL BE COORDINATED WITH TUB/WALVE. CONTRIBUTE GRAB BAR REQUIRED AT
	OTHER LOCATIONS.
NOTES: SEE PLUMBING FOR LOCATION OF ALL FLOOR DRAINS. SLOPE FLOORS TO FLOOR DRAINS, TYP. TOILET PARTITION DOOR PULLS SHALL BE INSTALLED ON THE INSIDE OF THE DOOR AND SHALL BE 48" MIN. FROM THE TOP OF THE DOOR AND 18" FROM THE BOTTOM. DO NOT INSTALL TOILET PARTITION DOOR PULLS ON THE INSIDE OF THE DOOR. SEE THE LATEST CODES AT 17 / (FOR 8.3.)	

NOTES:
 ONE (1) TOILET PARTITION DOOR SHALL BE 48" x 84" x 4 1/2"
 ABOUT 1/2" FROM THE INSIDE OF THE DOOR AND 18" FROM
 THE TOP OF THE DOOR. SEE THE LATEST CODES AT 17 / (FOR 8.3.)
 ALSO REFER TO THE EXISTING ARCHITECTURAL DRAWINGS.

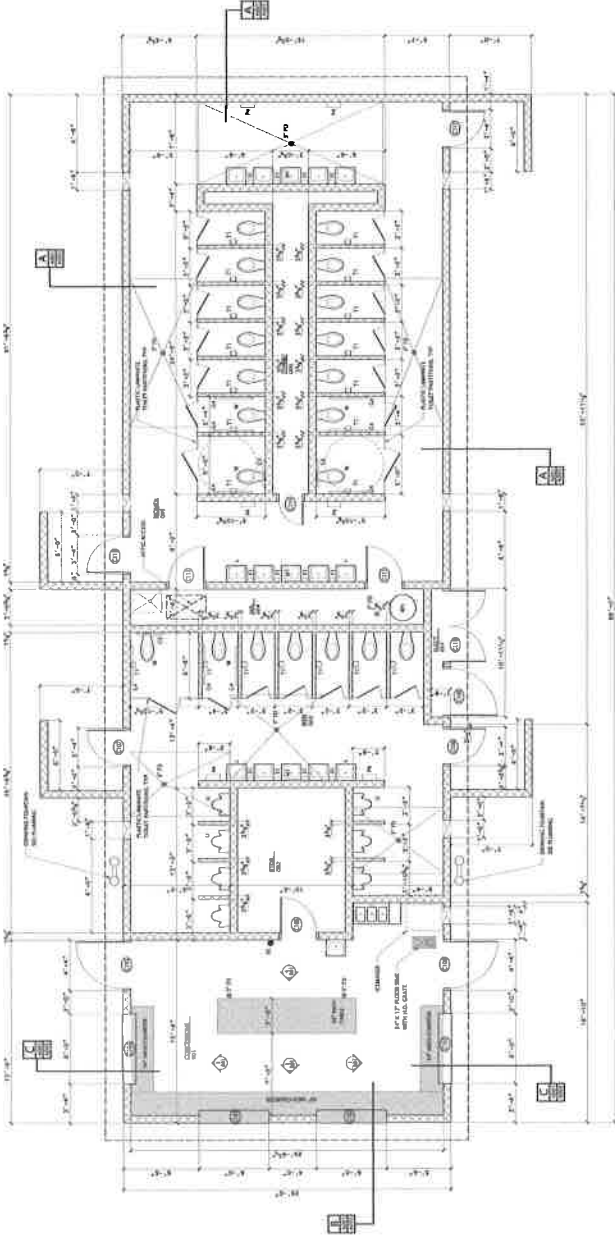

CONCESSIONS/REST ROOMS FLOOR PLAN

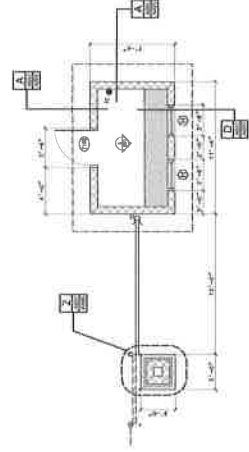
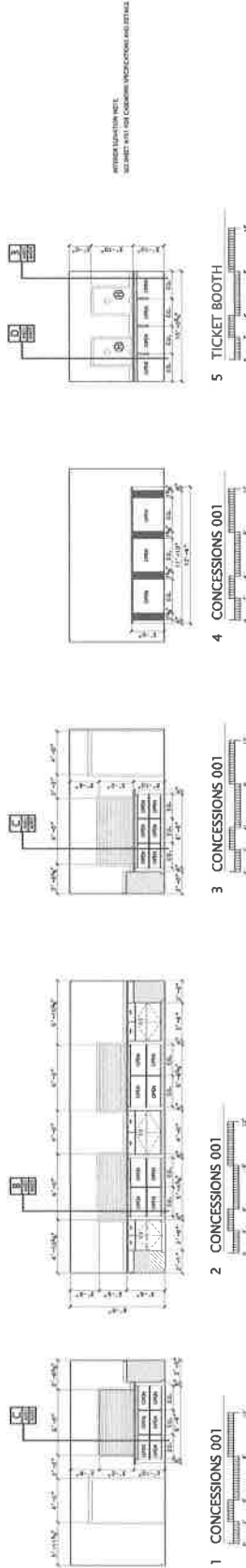

TICKET BOOTH FLOOR PLAN

