

1-4 DROP OFF – 7:50 AM

Kindy DROP OFF – 8:50 AM

We strive to keep our students safe at all points in their day, including drop off and pick up. Our bus drivers do an amazing job at providing safe transportation for hundreds of students. We also appreciate our parents'/guardians' efforts at keeping our car riders safe.

STUDENTS WILL ENTER AND EXIT CARS FROM THE PASSENGER (SIDEWALK) SIDE

- Operate your vehicle with increased care and awareness when driving the vicinity of our school building to drop off and/or pick up your child.
 - Please refrain from using your phone in the car drop off and pick up lines.
- Make sure your child is properly prepared for drop off (with coats, shoes, backpacks) and can exit your car in a timely fashion.
- Refrain from pulling around other cars in the drop off and pick up lines.
- Refer to the map to ensure you are following set traffic patterns.

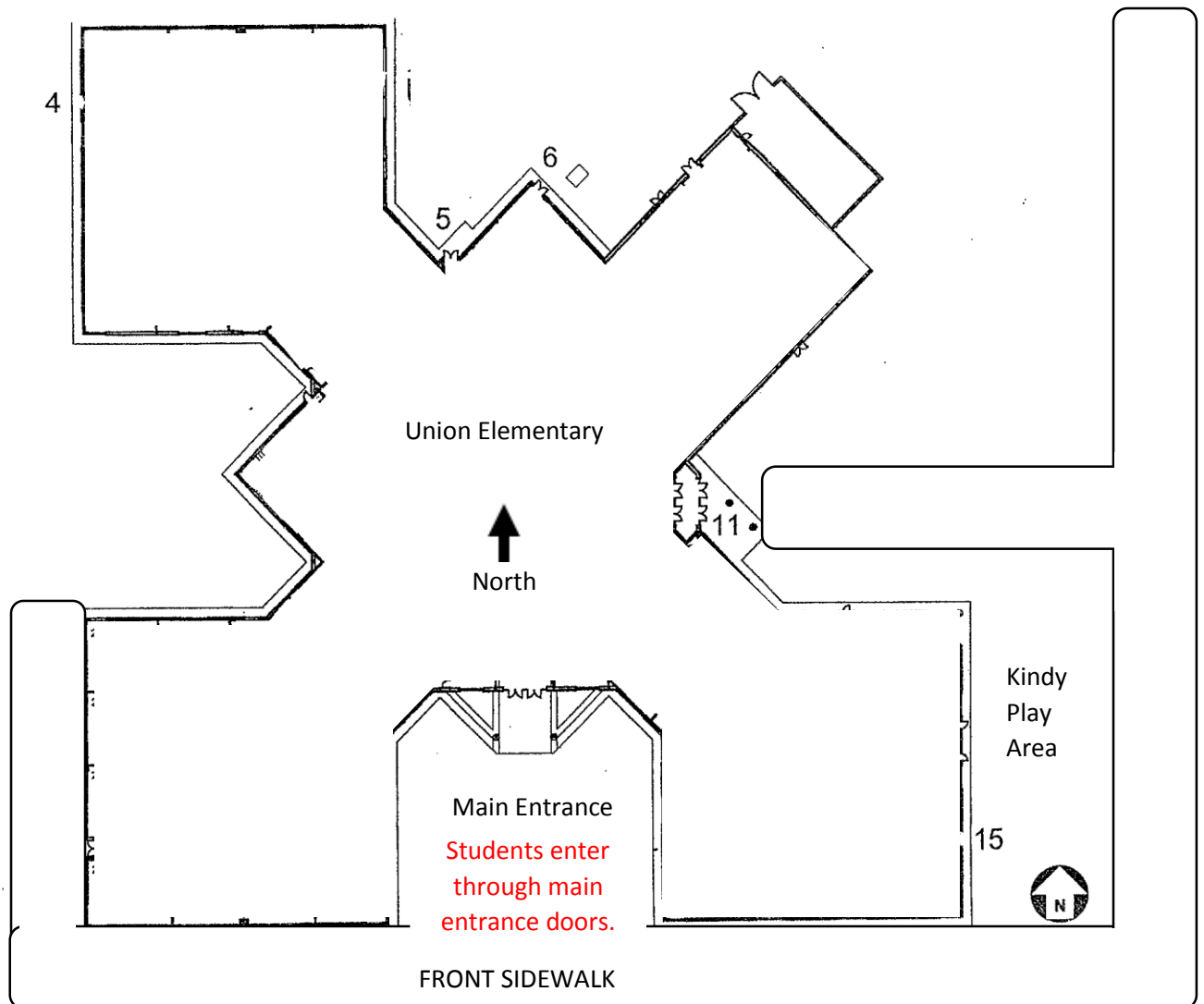

← AM Drop Off – Please keep car flow one way, one lane, and do not pass.