

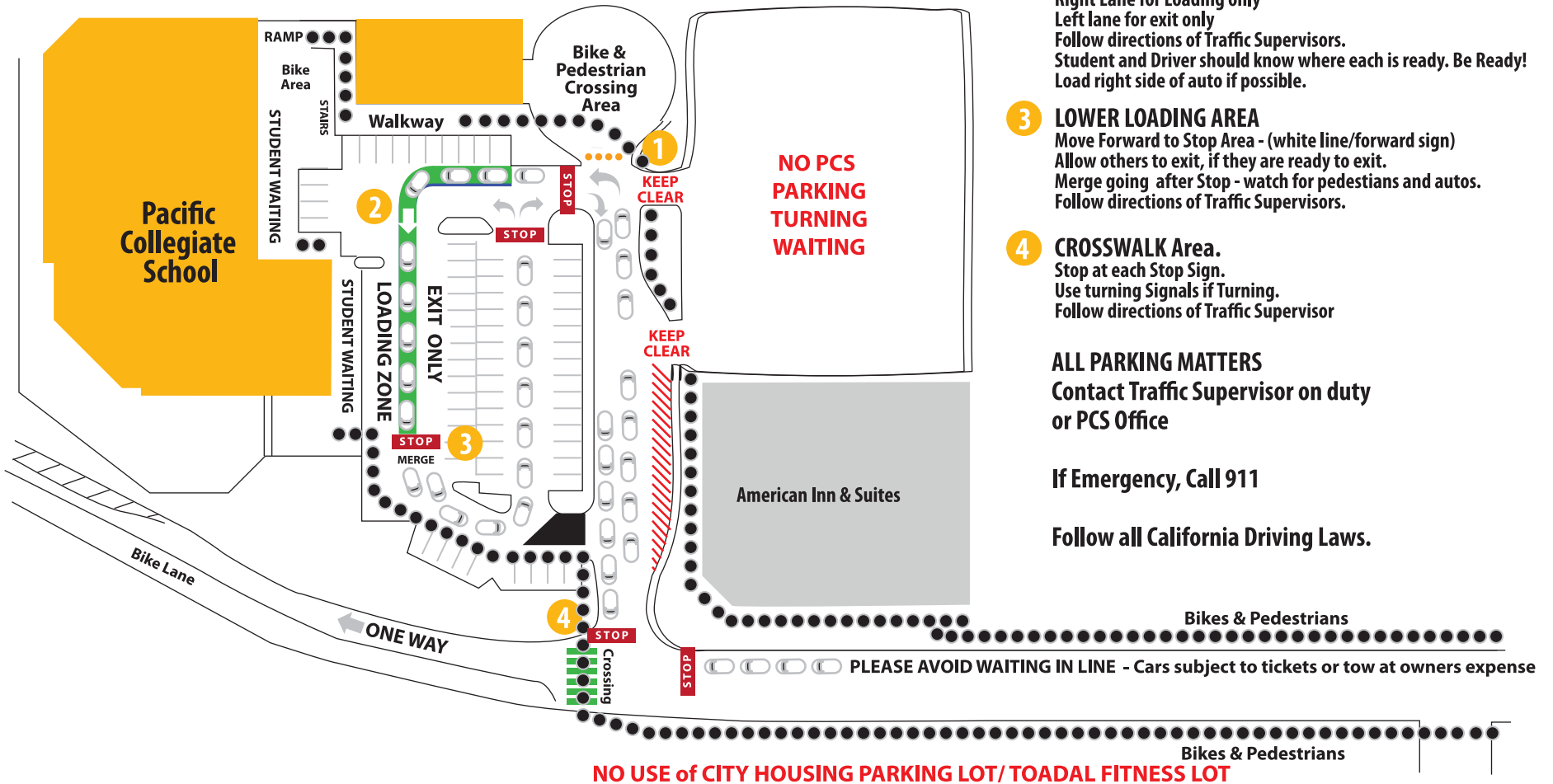

Traffic Safety Plan

Updated 2/22/2017



AREA Descriptions

- 1 UPPER ENTRANCE AREA.**
ENTER and EXIT PCS . Watchout for Pedestrians and Bikes.
Do not block Hotel Entrance - Keep Clear.
Do not block PCS Entrance - Keep Clear.
Follow directions of Traffic Supervisors.
Bike enter by Music Pod.
- 2 MAIN LOADING AREA**
Approach with caution!
Right Lane for Loading only
Left lane for exit only
Follow directions of Traffic Supervisors.
Student and Driver should know where each is ready. Be Ready!
Load right side of auto if possible.
- 3 LOWER LOADING AREA**
Move Forward to Stop Area - (white line/forward sign)
Allow others to exit, if they are ready to exit.
Merge going after Stop - watch for pedestrians and autos.
Follow directions of Traffic Supervisors.
- 4 CROSSWALK Area.**
Stop at each Stop Sign.
Use turning Signals if Turning.
Follow directions of Traffic Supervisor

ALL PARKING MATTERS
Contact Traffic Supervisor on duty
or PCS Office

If Emergency, Call 911

Follow all California Driving Laws.

NO USE of CITY HOUSING PARKING LOT/ TOADAL FITNESS LOT