

Kindergarten Lineup Locations and Procedures

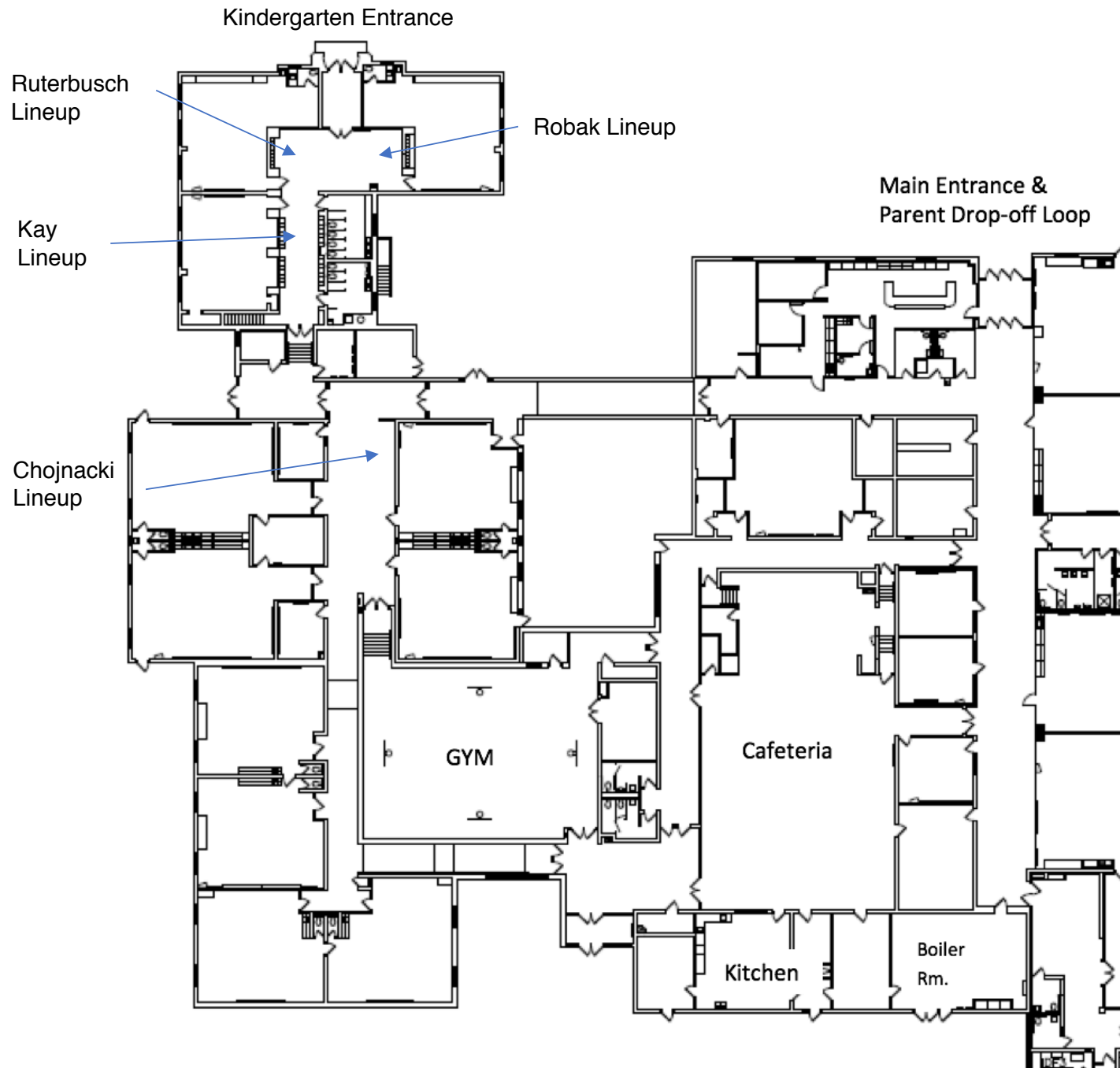

- Please do not drop your child off until 8:20 at the earliest. Once your child enters the building they can proceed to their marked lineup location. These areas are marked with signs in the hallways.
- Kindergarten families can use the kindergarten entrance. If you chose to use the kindergarten entrance you must park your car in the kindergarten lot and walk your child to the door.
- Students are always encouraged to take the bus whenever possible. Kindergarten parents can also drop their child off using the main entrance & parent drop off loop.



1st and 2nd Grade Lineup Locations and Procedures

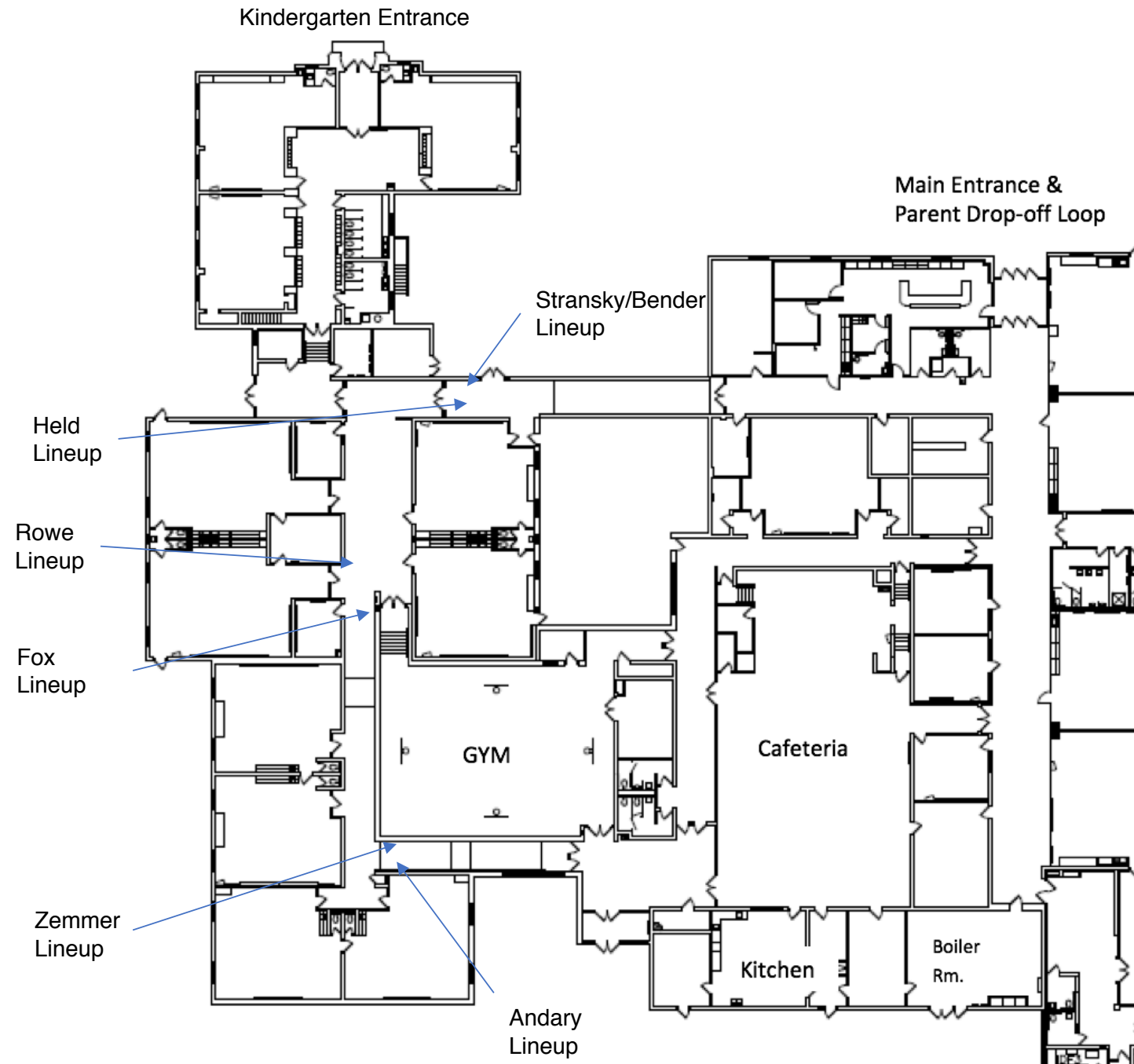

- Please do not drop your child off until 8:20 at the earliest. Once your child enters the building they can proceed to their marked lineup location. These areas are marked with signs in the hallways.
- Students are always encouraged to take the bus whenever possible. Parents can also drop their child off using the main entrance & parent drop off loop.



3rd, 4th and 5th Grade Lineup Locations and Procedures

- Please do not drop your child off until 8:20 at the earliest. Once your child enters the building they can proceed to their marked lineup location. These areas are marked with signs in the hallways.
- Students are always encouraged to take the bus whenever possible. Parents can also drop their child off using the main entrance & parent drop off loop.

