

Pre-School DROP OFF and PICK UP

Universal Pre-School – 8:10 AM (Drop Off) and 2:45 PM (Pick Up)*

We strive to keep our students safe at all points in their day, including drop off and pick up. Our bus drivers do an amazing job at providing safe transportation for hundreds of students. We also appreciate our parents'/guardians' efforts at keeping our car riders safe.

Pre-School students should be escorted by an adult at all times.

- Operate your vehicle with increased care and awareness when driving the vicinity of our school building to drop off and/or pick up your child.
 - Please refrain from using your phone in the car during this time.
- Make sure your child is properly prepared for drop off (with coats, shoes, backpacks) and can exit your car in a timely fashion.
- Refer to the map to ensure you are following set traffic patterns.
- **Please park in the lot south of the Kindy and PK Play Area.** Do not park in bus lot.

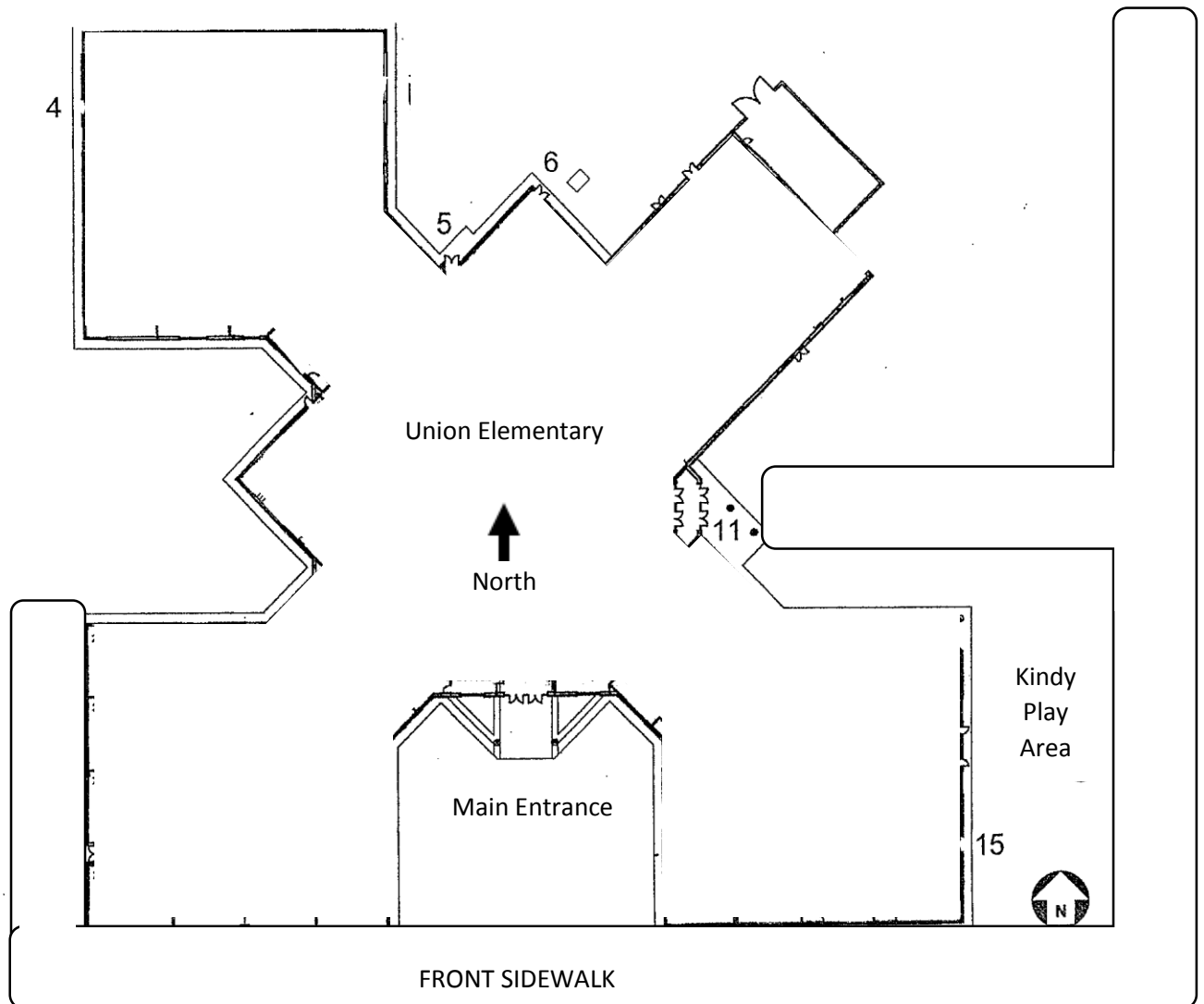

Please do not park in the bus lot.

***AM Drop Off** – Please keep car flow one way, one lane, and do not pass.

***PM Pick Up** – Please do not arrive before 3:40 P.M. as this will interfere with bus and car pickups



Please park in these spaces for PK